

UTM Residence Phase IX

DEFY  
GRAVITY



UNIVERSITY OF  
TORONTO  
MISSISSAUGA

# Project Overview

- 265 Units; 400 Beds
- Construction starting March 2024; Planned opening Summer 2026
- 6,538 NASMs, 10,088 GSMs

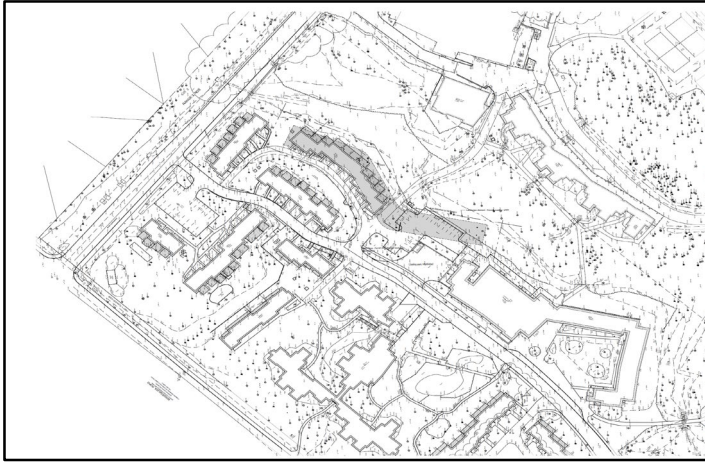

# Importance of Student Housing

- **First Year Guarantee**

- Residence is guaranteed to all new full-time students entering their first year of a postsecondary program for the first time, provided that they apply by the guarantee deadline of June 1.

- **UTM Enrolment and Residence Demand**

- Total annual intake target of 3,942, of which 2,662 (or 69.3%) relates to domestic and 1,180 (or 30.7%) relates to international students.
- While enrolment has continued to grow at UTM, we have not expanded our residence spaces since Oscar Peterson Hall was built 17 years ago, when UTM's enrolment was 8,574 students. UTM's 22/23 enrolment was 16,102.
- Waitlist for residence at UTM on Move In Day:  
Fall 2022: 536  
Fall 2023: 717

# Importance of Student Housing

- **Our new residence advances UTM's Strategic Priorities**

- 👤 Foster Student Success: e.g., enhances student experience and retention.
- 👥 Encourage Collaboration and Belonging: e.g., cultivates inclusive student community.
- 🌍 Build Efficient and Sustainable Operations: e.g., targets LEED Silver, delivers sound market return.
- 📍 Embrace Our Place: e.g., opens much-needed housing for Peel Region.

# Importance of Student Housing

- **Value of Living and Learning in Residence (VLLR)**

- **VLLR Project Overview**

- The objective of this study was to determine if there are statistically significant differences between students who lived in residence in first-year compared to students who lived off-campus in first-year.
- Data was provided by UTM's Office of the Registrar, as well as Student Housing and Residence Life, and contained 35,567 records for first-year full-time students who started at UTM over the period 2008 to 2018.

- **Findings**

- At UTM, the first year GPA of students who lived in residence was slightly higher than those who lived off campus.
- For international students, living in residence is an extremely valuable intervention to support student success.



# Visuals

---



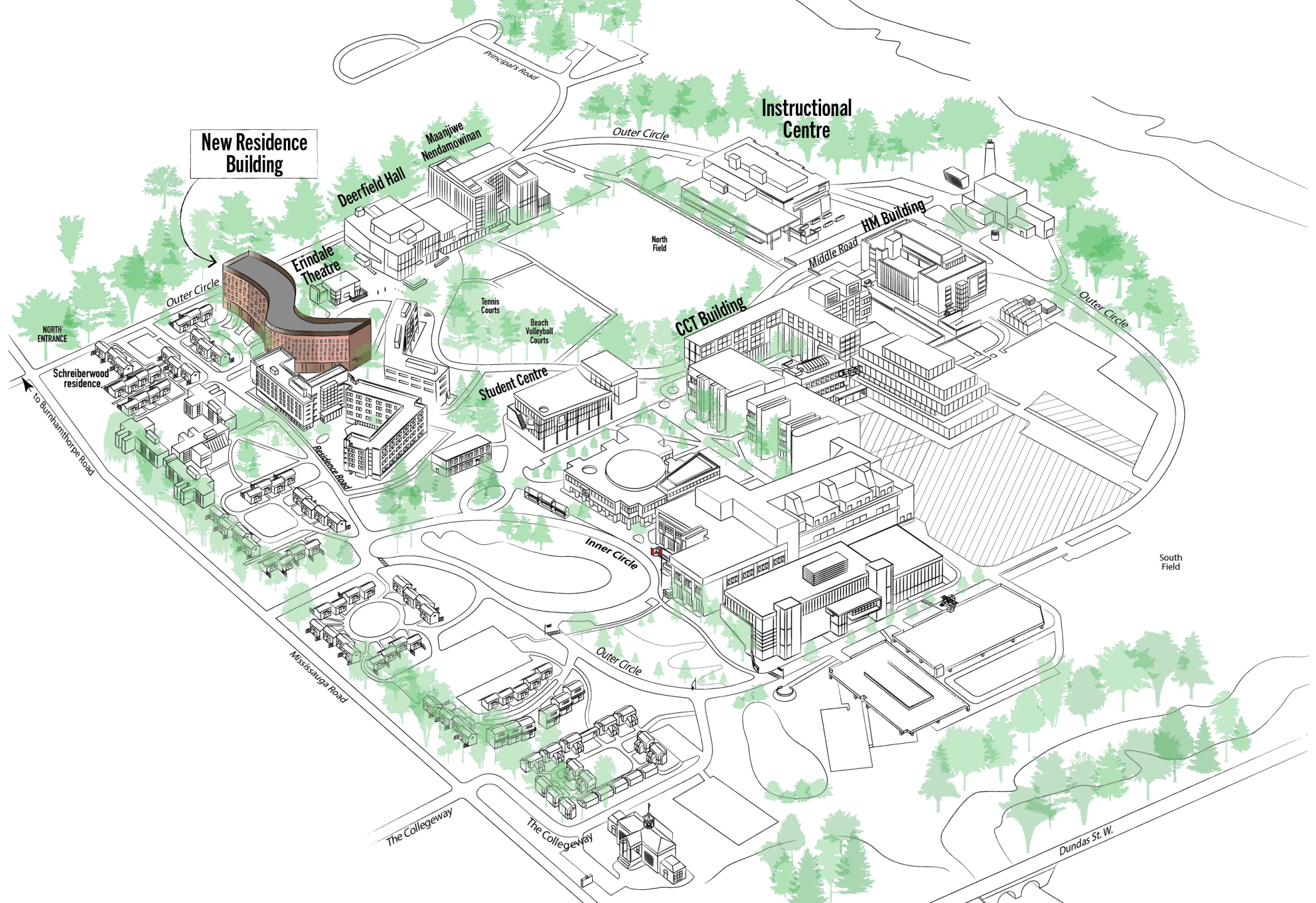





























# Questions

---