



# Capital Project and Real Estate: Annual Review to December 31, 2016

## Presentation to Business Board

Monday, February 27, 2017

# KEY METRICS 2016 PROJECTS

TPC Value of Project	Number of Projects
< \$3,000,000	121
\$3M to \$25M	22
\$25M to \$75M	8
\$75M	5
No Value Assigned	10
<b>Total Number of Projects</b>	<b>166</b>

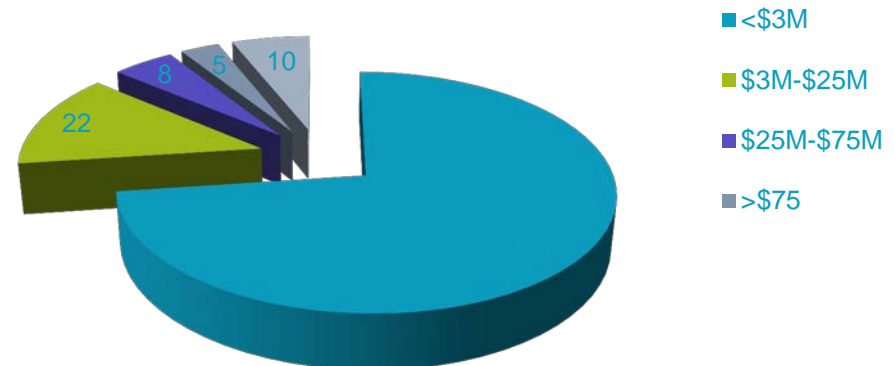

Total # of Projects: 166

## KEY METRICS

# TPC \$VALUE OF 2016 PROJECTS: \$1,057M

Project Range / # of Projects	Total TPC Value
< \$3M (121 projects)	\$108.1M
\$3M to \$25M (22 projects)	\$215.4M
\$25M to \$75M (8 projects)	\$309.7M
> \$75M (5 projects)	\$423.8M
<b>Total TPC Value</b>	<b>\$1,057M</b>

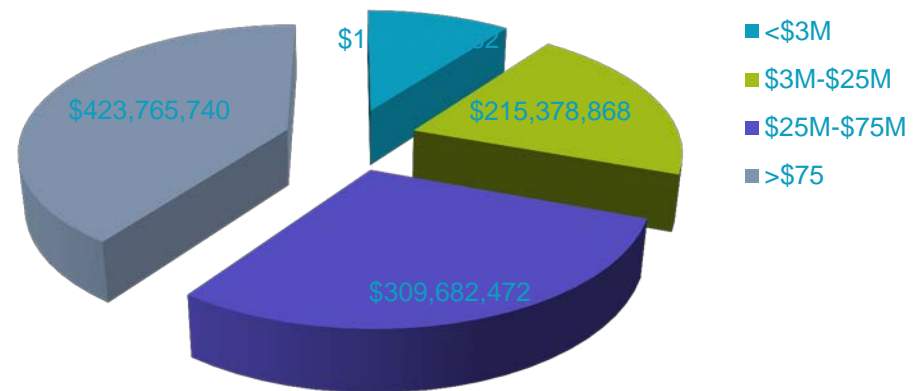

Total TPC Value: \$1,056,899,642

# KEY METRICS COMPARISON OF STATISTICS

	2013		2014		2015 (to 30 Sept)		2016	
Project Range/ #of Proj	# Proj	Total TPC Value	# Proj	Total TPC Value	# Proj	Total TPC Value	# Proj	Total TPC Value
<\$3M	55	\$43M	67	\$63M	76	\$65M	121	\$108M
\$3M to \$10M	5	\$21M	6	\$21M	8	\$35M	30	\$525M
\$10M to \$30M	3	\$54M	6	\$93M	7	\$110M		
>\$30M	6	\$378M	9	\$371M	7	\$432M		
\$25M to \$75M								
>\$75M							5	\$424M
In design, value n/a							10	
	<b>69</b>	<b>\$496M</b>	<b>88</b>	<b>\$548M</b>	<b>98</b>	<b>\$642M</b>	<b>166</b>	<b>\$1,057M</b>

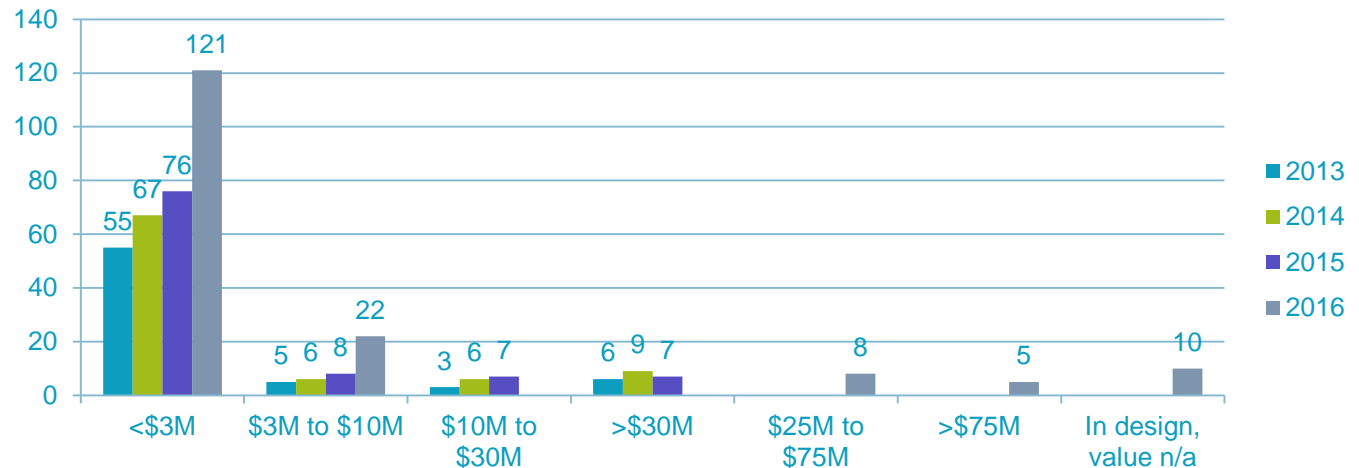



# KEY METRICS PROJECT QUANTITY COMPARISONS

Project Range	% Number of Projects	% Value of Projects
< \$3,000,000	73%	10%
\$3M to \$25M	13%	20%
\$25M to \$75M	5%	29%
> \$75M	6%	40%



# HIGHLIGHTED CAPITAL PROJECTS IN DESIGN



# HIGHLIGHTED CAPITAL PROJECTS IN DESIGN

1. New College Plaza
2. Student Commons
3. Landscape of Landmark Quality
4. UC Revitalization
5. Willcocks Commons

# HIGHLIGHTED CAPITAL PROJECTS IN DESIGN

Project	Schedule	Size
New College Plaza	Completion: Summer 2016	n/a
Student Commons	Completion Summer 2018	6 735 GSM
Landscape of Landmark Quality	n/a	Front Campus
UC Revitalization	Completion: 2018	1 634 GSM





NEW COLLEGE PLAZA

University of Toronto

V+A







UNIVERSITY OF  
TORONTO

**STUDENT COMMONS**  
ARCHITECT: superkül  
AREA: 6735 GSM



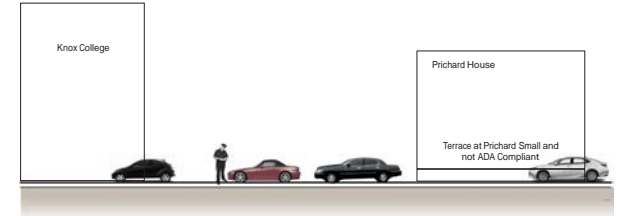
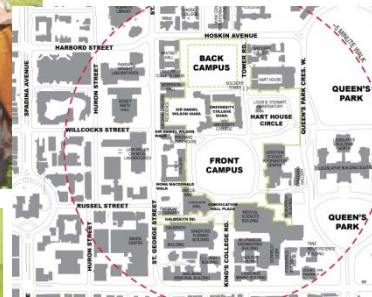

BEFORE

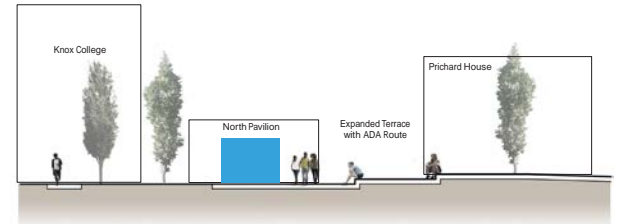

AFTER



**LANDSCAPE of LANDMARK QUALITY DESIGN COMPETITION**  
**CONSULTANTS: KPMB, Michael Van Walkenburgh Associates and Urban Strategies**

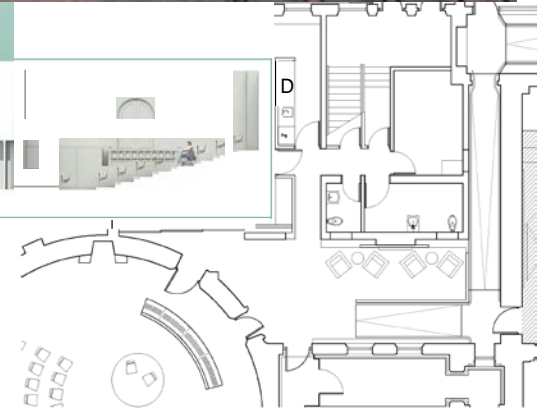
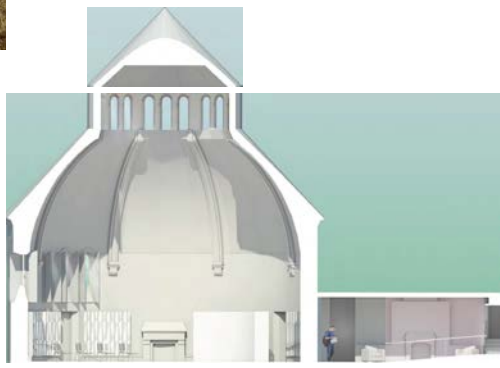
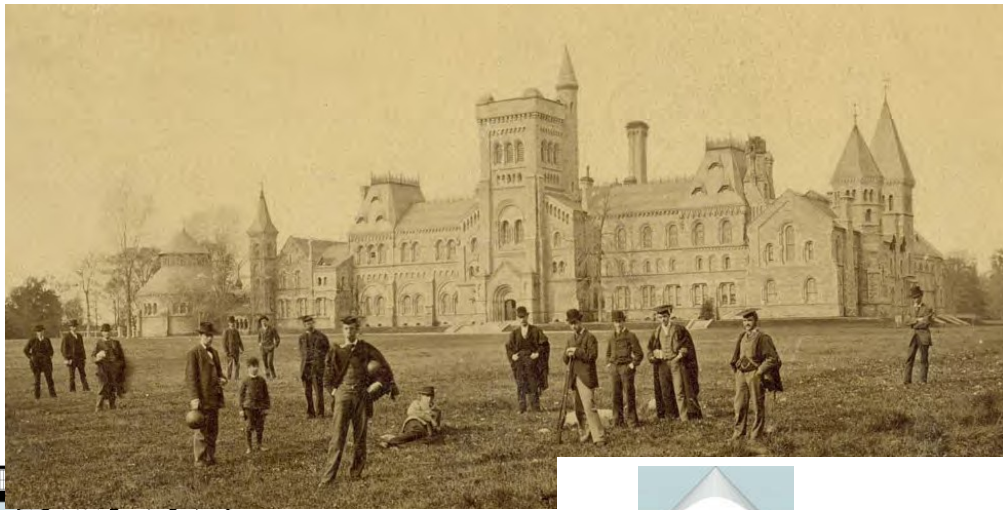

**UNIVERSITY COLLEGE REVITALIZATION**  
ARCHITECT: Kohn Shnier  
AREA: 1634 GSM





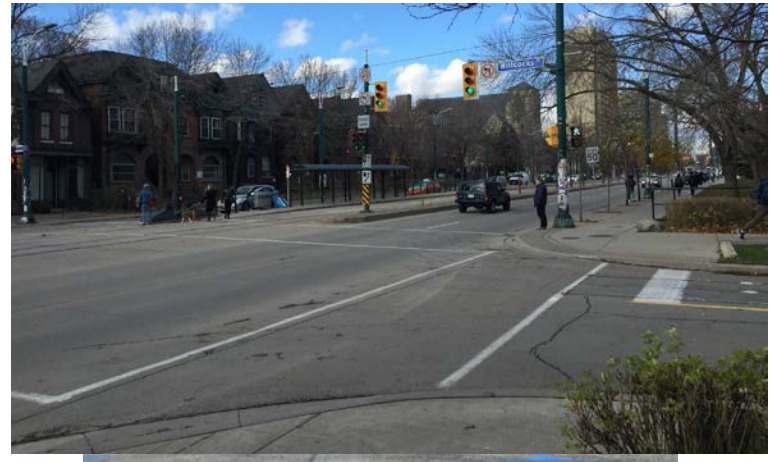

**WILCOCKS COMMONS**  
**CONSULTANT: DTAH**



# HIGHLIGHTED CAPITAL PROJECTS UNDER CONSTRUCTION



UNIVERSITY OF  
TORONTO



# HIGHLIGHTED CAPITAL PROJECTS UNDER CONSTRUCTION

1. Centre for Engineering Innovation & Entrepreneurship (CEIE)
2. Daniels Faculty of Architecture, Landscape & Design
3. Ramsay Wright Laboratories
4. Highland Hall, UTSC
5. Jackman Institute of Child Study
6. UTM North B

# HIGHLIGHTED CAPITAL PROJECTS UNDER CONSTRUCTION

Project	Completion	Size
CEIE - Centre for Engineering Innovation & Entrepreneurship	Completion: October 2017	15 000 GSM
Daniels Faculty of Architecture Landscape and Design	January 2017	750 GSM
Ramsay Wright Teaching Labs Renovation	Completion: December 2017	5 840 GSM
Highland Hall, UTSC	Completion: June 2017	13 572 GSM
Dr. Eric Jackman Institute of Child Study Expansion	Completion: September 2017	2360 GSM (Addition) 1250 GSM (Renovation)
UTM North Building – Phase B	Completion: July 2018	20 954 GSM







**CENTRE for ENGINEERING INNOVATION & ENTREPRENEURSHIP (CEIE)**

**ARCHITECT: Montgomery Sisam Architects & Feilden Clegg Bradley Studios**

**SCHEDULED COMPLETION: August 2017**

**AREA: ~15 000 GSM**

**TPC: \$99.9M**





**1 SPADINA CRESCENT – JOHN H. DANEILS FACULTY OF ARCHITECTURE, LANDSCAPE & DESIGN**

**ARCHITECT: NADAAA & Adamson Associates Architects**

**COMPLETION: January 2017**

**AREA: 750 GSM**





**LEGEND:**

- MEDIA TEACHING ZONE
- SERVICES ZONE
- FUME HOOD (additional mech. requirements to be considered)
- VISUAL CONNECTION TO CORRIDOR (science on display)

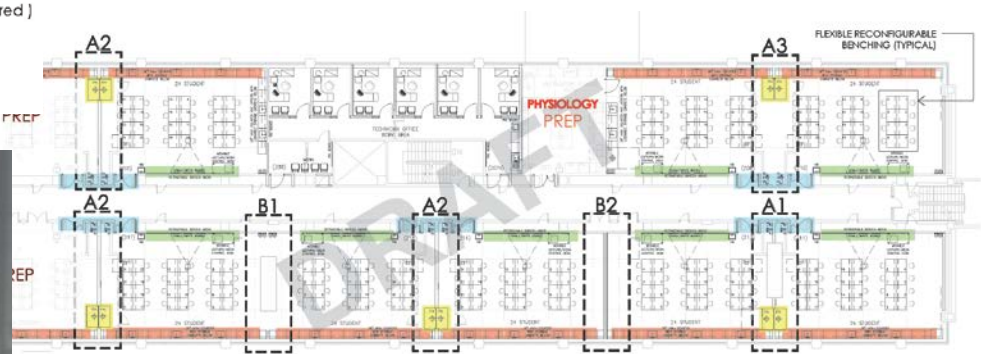

**RAMSAY WRIGHT LABORATORIES**

ARCHITECT: DIALOG Design

COMPLETION: December 2017 (Phased completion)

AREA: 5840 GSM

TPC: \$24.3M



UNIVERSITY OF  
**TORONTO**





## HIGHLAND HALL, UTSC

ARCHITECT: Perkins + Will

SCHEDULED COMPLETION: June 2017

RENO AREA: 5,261 GSM

NEW: 8,311 GSM

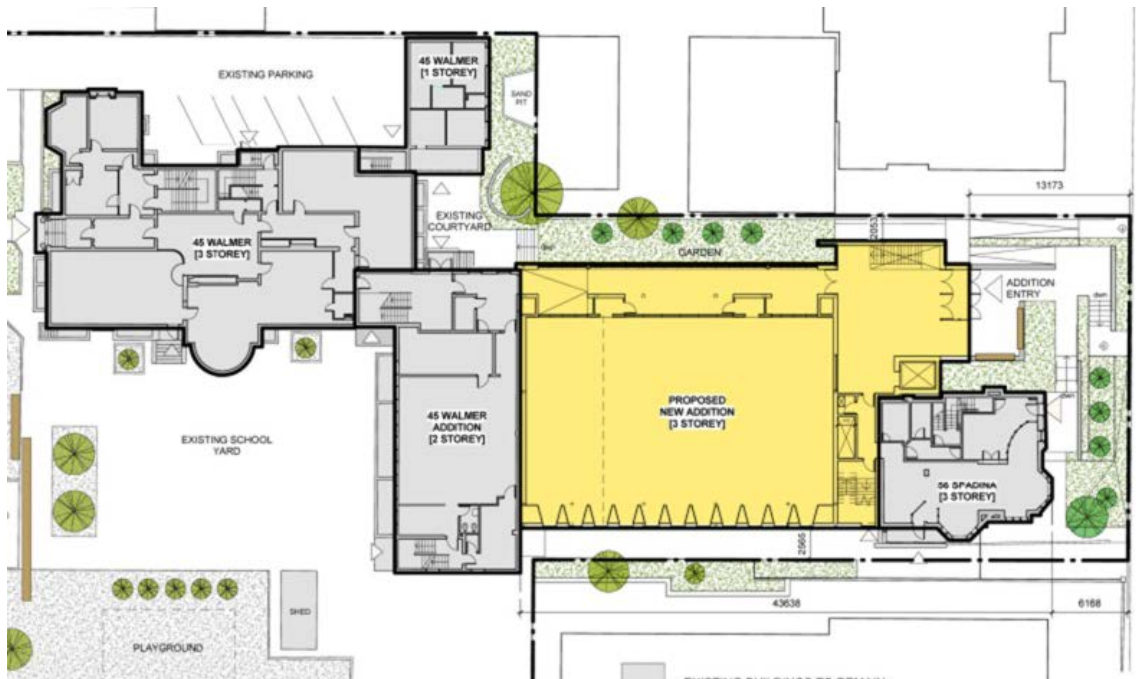

**JACKMAN INSTITUTE of CHILD STUDY**  
ARCHITECT: Taylor Smyth Architects  
SCHEDULED COMPLETION: September 2017  
AREA: 2360 GSM (Addition), 1250 GSM (Renovation)





**UTM NORTH BUILDING – PHASE B**  
**ARCHITECT:** Perkins + Will  
**CONTRACTOR:** Stuart Olson Construction Ltd.  
**SCHEDULED COMPLETION:** July 2018  
**AREA:** 20 954 GSM



# HIGHLIGHTED CAPITAL PROJECTS COMPLETED & OCCUPIED



# HIGHLIGHTED CAPITAL PROJECTS COMPLETED & OCCUPIED

1. UTM Greenhouse
2. UTM Parking Structure
3. MaRS 15/16 Faculty of Medicine
4. Faculty of Law



# HIGHLIGHTED CAPITAL PROJECTS COMPLETED & OCCUPIED

Project	Completion	Budget	Size
UTM Parking Deck Expansion	Completion: October 2016	TBD	292 parking spaces
UTM Greenhouse	February 2016	\$4.97M	360 GSM
MaRS 15/16 Faculty of Medicine	May 2016	\$17.6M	6 000 GSM
Faculty of Law	April 2016	\$57M	15 125 GSM

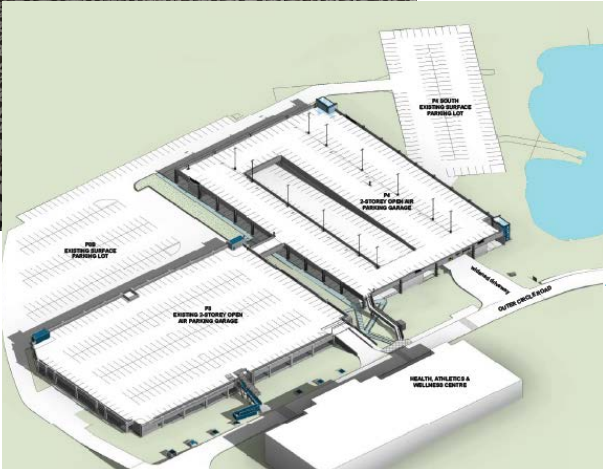

**UTM PARKING DECK EXPANSION**  
CONSULTANT: RJC Consulting Engineers  
NUMBER OF NEW SPACES: 292  
COMPLETION: October 2016





**UTM GREENHOUSE**  
**ARCHITECT:** Baird Sampson Neuert  
**CONTRACTOR:** Dineen Construction  
**COMPLETION:** February 2016  
**AREA:** 360 GSM  
**TPC:** \$4.97M





**MaRS 15/16 FACULTY of MEDICINE**

**ARCHITECT:** Perkins + Will

**CONTRACTOR:** Eastern Construction

**COMPLETION:** May 2016

**AREA:** 6000 GSM

**TPC:** \$17.6M



**Faculty of Law Expansion**

**ARCHITECT: B+H**

**CONTRACTOR: Eastern Construction**

**COMPLETION: April 2016**

**AREA: 15125 GSM**

**TPC: \$57M**

